

HAVA

Mining and Rock Breaking Air Tools



PAVEMENT BREAKER

FAST

POWERFUL

STRONG

EASY TO HANDLE

www.havarock.com

INTRODUCTION

PAVEMENT BREAKER

“HAVA” Pavement Breaker is a medium duty Breaker and is designed to operate most efficiently at 80 to 90 psi.

It is often used as a Demolition Tool for a variety of applications.

- ▣ Pavement & Concrete Breaking
- ▣ Demolition Tool
- ▣ General Surface Work



ASSEMBLY CAUTIONS / OPERATING INSTRUCTIONS

1. Pull up the Backhead Bolts to tighten evenly, tightened alternating from one to the other to distribute the load and to minimise bolt failure.
2. Fronthead Bolt Nuts should be evenly tightened in order to compress the springs evenly but not so tightly that the coil collapse or become “solid” torque. The springs should each be evenly compressed from 3.2mm to 4.8mm which will give the springs an assembled length from 58.7mm to 60.3mm.
3. It is necessary for checking purposes, to operate the tool on the floor at reduced throttle to avoid damage to the piston, anvil block and Front Head.
4. Be sure that steels are not over-dull and that steels and shanks are of the correct size and length. Inspect steels and do not use those chipped or rounded on the striking end. Shanks of improper length reduce the effectiveness of the blow.
5. Please see that the Backhead and Fronthead Bolts are tightened regularly. If the tool is run with one bolt loose, some parts may get destroyed because of misalignment and the remaining bolts will be overstressed leading to breakage.
6. Demolition Tools are designed to operate most efficiently at 80 to 90-p.s.i.g. air pressure. Roughness and Excessive breakage will result from operation at higher pressure while low pressure will cause slowness & inefficient operation.

AIR REQUIREMENT

HAVA Pavement Breaker requires air at a steady 80-90 PSIG (5.6-6.3 bar) pressure.

The pipes should be with size 3/4” internal diameter.

We recommended an Airline Lubricator to provide sufficient lubrication so as to improve performance. The HAVA HR 117 Breaker consumes 88Cfm of air in continuous operation.

Do's and Don'ts

1. Daily blow out hoses and ensure hoses are in good condition and clean.
2. Pour in an ounce of oil into the air inlet before connecting hoses.
3. Do not operate tool without the chisel being in contact with the works.
4. Ensure chisels are in top condition, i.e. well sharpened.
5. Retighten bolts on the breaker to recommended torques frequently.
6. When not in use, plug openings to avoid ingress of dirt.
7. Observe safety precautions.
8. Never operate at pressure over 90 PSIG (6.3 bar)

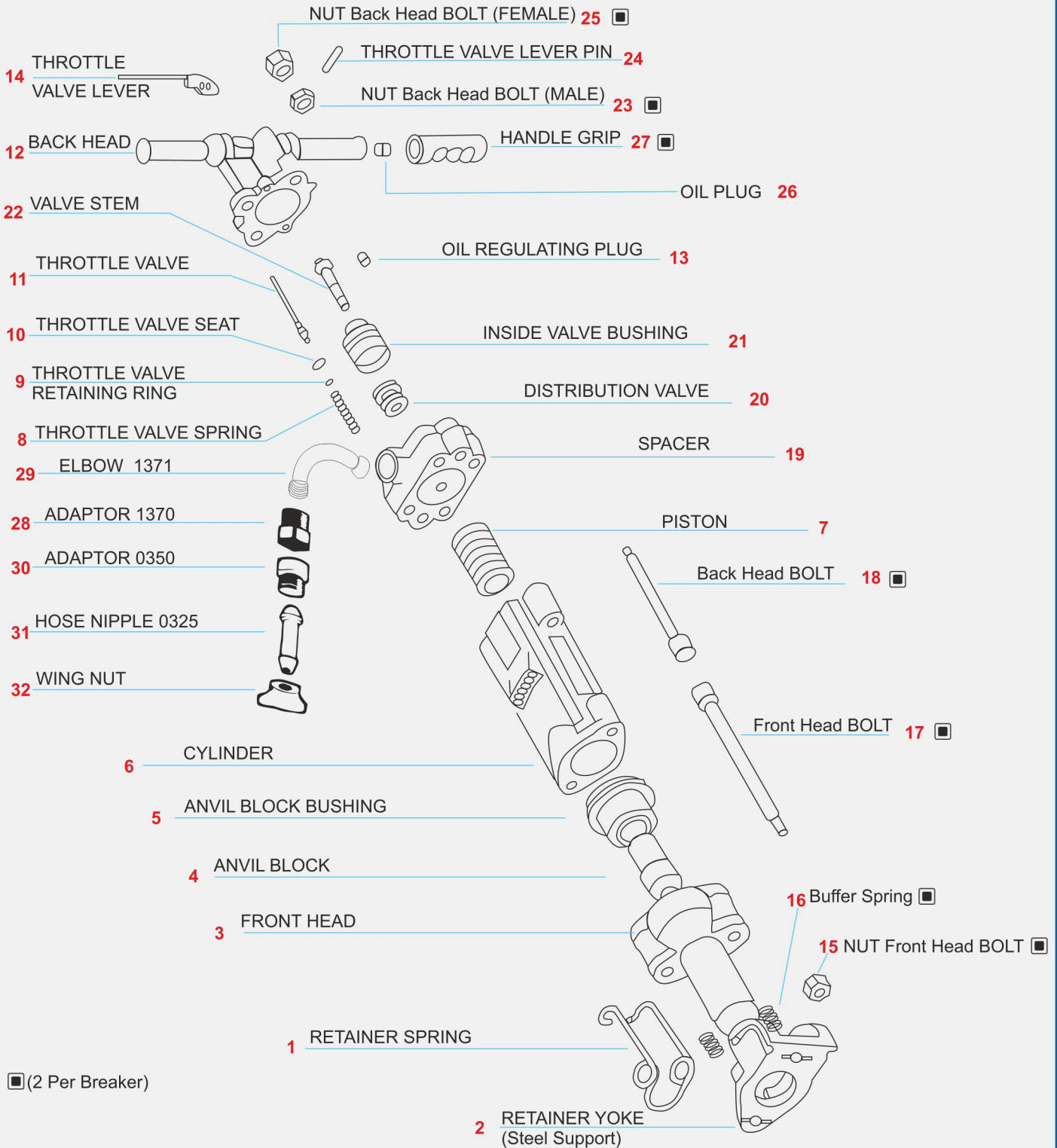

■ (2 Per Breaker)

TECHNICAL DATA

MODEL	WEIGHT	AIR CONSUMPTION		PISTON	OVERALL LENGTH		FREQUENCY	HOSE CONNECTION	
		(at 6 bar) m ³ /Min	(87 PSI) Cfm		Diameter MM	mm		inch	RATE bpm
HR 117	Kg								
-	36	2.5	88	57	710	28	1200	19	3/4



HAVA

HARYOCK ENGINEERING PVT. LTD.

A-55, 'H' Block, MIDC, Pimpri, Pune - 411018, INDIA.

Customer Care: +91-20-27440025/26

Email: haryockengg@gmail.com / sales.haryock@gmail.com

Visit us at: www.havarockdrill.com / www.haryock.com